

TYPE CSWD

Features

- Manufactured from high strength seamless copper tubing
- Electro-Tin plated
- Chamfered entry
- Color coded
- Suitable for use in circuits rated 35KV or less, proper high voltage spacing and insulation techniques must be used
- UL Listed and CSA Certified with ILSCO and major competitor's compression tools
- UL467 Listed 500 kcmil - 8 AWG , #8 - #2 SOL
- Rated to 90° C

Benefits

- Offers maximum conductivity and excellent crimping characteristics
- Provides low contact resistance
- For easy conductor insertion
- Identifies the proper compression die
- Application versatility
- Reduces inventory requirements
- For grounding and bonding applications

A

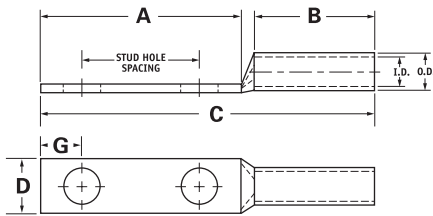

Catalog Number	Wire Size	Alt Wire Size	Expanded* Wire Range	Bolt Size	Stud Hole Dia.	Stud Hole Spacing	Dimensions					Die Color Code	Die Index	O.D.	I.D.
							A	B	C	D	G				
CSWD-2-10-34	#2 AWG	#2 SOL	2-6 AWG	10	0.219	0.750	1.437	0.625	2.348	0.599	0.258	Brown	I-33	0.421	0.312
CSWD-2-14-58	#2 AWG	#2 SOL	2-6 AWG	1/4	0.281	0.625	1.437	0.625	2.348	0.599	0.320	Brown	I-33	0.421	0.312
CSWD-2-14-34	#2 AWG	#2 SOL	2-6 AWG	1/4	0.281	0.750	1.437	0.625	2.348	0.599	0.320	Brown	I-33	0.421	0.312
CSWD-2-14-1	#2 AWG	#2 SOL	2-6 AWG	1/4	0.281	1.000	1.687	0.625	2.598	0.599	0.320	Brown	I-33	0.421	0.312
CSWD-2-516-34	#2 AWG	#2 SOL	2-6 AWG	5/16	0.343	0.750	1.687	0.625	2.598	0.599	0.352	Brown	I-33	0.421	0.312
CSWD-2-516-1	#2 AWG	#2 SOL	2-6 AWG	5/16	0.343	1.000	1.937	0.625	2.848	0.599	0.352	Brown	I-33	0.421	0.312
CSWD-2-38-34	#2 AWG	#2 SOL	2-6 AWG	3/8	0.406	0.750	1.687	0.625	2.598	0.599	0.414	Brown	I-33	0.421	0.312
CSWD-2-38-78	#2 AWG	#2 SOL	2-6 AWG	3/8	0.406	0.875	1.937	0.625	2.848	0.599	0.414	Brown	I-33	0.421	0.312
CSWD-2-38-1	#2 AWG	#2 SOL	2-6 AWG	3/8	0.406	1.000	1.937	0.625	2.848	0.599	0.414	Brown	I-33	0.421	0.312
CSWD-2-38-134	#2 AWG	#2 SOL	2-6 AWG	3/8	0.406	1.750	2.625	0.625	3.536	0.599	0.414	Brown	I-33	0.421	0.312
CSWD-2-12-134	#2 AWG	#2 SOL	2-6 AWG	1/2	0.562	1.750	3.000	0.625	3.911	0.750	0.546	Brown	I-33	0.421	0.312
CSWD-1-14-58	#1 AWG	#2 FLEX	1-6 AWG	1/4	0.281	0.625	1.437	0.625	2.392	0.673	0.320	Green	I-37	0.468	0.359
CSWD-1-14-34	#1 AWG	#2 FLEX	1-6 AWG	1/4	0.281	0.750	1.437	0.625	2.392	0.673	0.320	Green	I-37	0.468	0.359
CSWD-1-14-1	#1 AWG	#2 FLEX	1-6 AWG	1/4	0.281	1.000	1.687	0.625	2.642	0.673	0.320	Green	I-37	0.468	0.359
CSWD-1-516-78	#1 AWG	#2 FLEX	1-6 AWG	5/16	0.343	0.875	1.687	0.625	2.642	0.673	0.352	Green	I-37	0.468	0.359
CSWD-1-516-1	#1 AWG	#2 FLEX	1-6 AWG	5/16	0.343	1.000	1.937	0.625	2.892	0.673	0.352	Green	I-37	0.468	0.359
CSWD-1-38-1	#1 AWG	#2 FLEX	1-6 AWG	3/8	0.406	1.000	1.937	0.625	2.892	0.673	0.414	Green	I-37	0.468	0.359
CSWD-1-12-134	#1 AWG	#2 FLEX	1-6 AWG	1/2	0.562	1.750	3.000	0.625	3.955	0.750	0.546	Green	I-37	0.468	0.359
CSWD-1/0-14-58	1/0 AWG	#1 FLEX	1/0-6 AWG	1/4	0.281	0.625	1.437	0.750	2.543	0.738	0.320	Pink	I-42	0.515	0.390
CSWD-1/0-14-34	1/0 AWG	#1 FLEX	1/0-6 AWG	1/4	0.281	0.750	1.437	0.750	2.543	0.738	0.320	Pink	I-42	0.515	0.390
CSWD-1/0-14-1	1/0 AWG	#1 FLEX	1/0-6 AWG	1/4	0.281	1.000	1.687	0.750	2.793	0.738	0.320	Pink	I-42	0.515	0.390
CSWD-1/0-516-34	1/0 AWG	#1 FLEX	1/0-6 AWG	5/16	0.343	0.750	1.687	0.750	2.793	0.738	0.352	Pink	I-42	0.515	0.390
CSWD-1/0-516-78	1/0 AWG	#1 FLEX	1/0-6 AWG	5/16	0.343	0.875	1.687	0.750	2.793	0.738	0.352	Pink	I-42	0.515	0.390
CSWD-1/0-516-1	1/0 AWG	#1 FLEX	1/0-6 AWG	5/16	0.343	1.000	1.937	0.750	3.043	0.738	0.352	Pink	I-42	0.515	0.390
CSWD-1/0-38-1	1/0 AWG	#1 FLEX	1/0-6 AWG	3/8	0.406	1.000	1.937	0.750	3.043	0.738	0.414	Pink	I-42	0.515	0.390
CSWD-1/0-38-134	1/0 AWG	#1 FLEX	1/0-6 AWG	3/8	0.406	1.750	2.625	0.750	3.731	0.738	0.414	Pink	I-42	0.515	0.390
CSWD-1/0-12-1	1/0 AWG	#1 FLEX	1/0-6 AWG	1/2	0.562	1.000	2.125	0.750	3.231	0.738	0.546	Pink	I-42	0.515	0.390
CSWD-1/0-12-134	1/0 AWG	#1 FLEX	1/0-6 AWG	1/2	0.562	1.750	3.000	0.750	4.106	0.738	0.546	Pink	I-42	0.515	0.390

All wire sizes, unless noted otherwise, are American Wire Gauge (AWG)

* When installed with specified dieless tools + See pages 87 to 93 for complete tooling information. For Bent Tangs change the 4th letter to a B and add "-4" for 45 deg. or "-9" for 90 deg.

UL File E6207